



File Name: Bth 199 970 manual.pdf

Size: 4439 KB

Type: PDF, ePub, eBook

Category: Book

Uploaded: 25 May 2019, 12:39 PM

Rating: 4.6/5 from 565 votes.

Download Now!

Please check the box below to proceed.



I'm not a robot



reCAPTCHA
Privacy - Terms

Book Descriptions:

Bth 199 970 manual



We appreciate your confidence in our products. Continued manual resetting of high limit control, preceded by higher than usual water temperature is evidence of high limit switch operation. The following are possible reasons for high limit switch operation. When directly communicating with the outdoors through vertical ducts, two permanent openings, located in the above manner, shall be provided. Each opening shall have a free area of not less than one square inch 6.5 cm per 4000 Btuh of the total input of all appliances in the enclosure. HORIZONTAL VENT FIGURE 6 7 ON DIRECT VENT INSTALLATIONS, EXHAUST VENT HOOD MUST BE LOCATED 1 30.5cm MINIMUM FROM ANY OPENING IN BUILDING. ON DIRECT VENT INSTALLATIONS, EXHAUST VENT HOOD MUST BE LOCATED 4 122cm MINIMUM FROM ANY OPENING IN BUILDING. Page 8 TRANSMITTED INTO THE LIVING SPACES. THE AIR INTAKE see Figure 8 PROVIDED ON THE UNIT. Page 10 FIGURE 11 VERTICAL VENT TERMINAL INSTALLATION IMPORTANT WHEN TERMINATING THROUGH A ROOF, THE FOLLOWING SPECIFICATIONS PERTAINING TO TERMINAL LOCATION MUST BE FOLLOWED. 1. Proper support must be provided for all pipe protruding through the roof. 2. The vertical roof terminations should be sealed with a plumbing roof boot or equivalent flashing. 3. The intake vent termination and the exhaust vent termination must penetrate the same side of roof. 4. Page 11 D. Know your own qualifications or those of your contractor. This switch is a positive pressure switch that requires an increase in pressure to change the electrical contacts from normally closed to open. Page 13 GAS METER SIZE CITY GASES ONLY CONNECTION OF GAS PIPE 1. When connecting gas pipe to unit, apply wrench to flange only. Note Do not use wrench on gas valve or gas bracket. See Figure 15. 2. PERFORM THE GAS LEAK TEST ANY TIME WORK IS DONE ON A GAS SYSTEM TO AVOID THE POSSIBILITY OF FIRE OR EXPLOSION WITH PROPERTY DAMAGE, PERSONAL INJURY OR LOSS OF LIFE. Page 14

4. <http://alliedteamworkconstruction.com/nbloom/fckuploads/dc460-manual-creaser.xml>

- **bth 199 970 manual, bth 199 970 service manual, ao smith bth 199 970 manual, bth 199 970 manual, bth 199 970 manual pdf, bth 199 970 manual download, bth 199 970 manual free, bth 199 970 manual for sale, ao smith bth 199 970 manual, bth 199 970 service manual.**

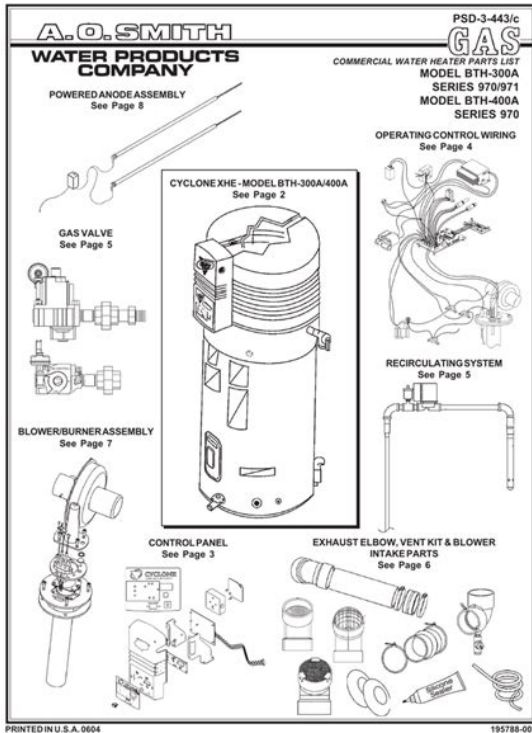

When the system requires water for space heating at temperatures higher than required for domestic water purposes, a tempering valve must be installed. Please refer to installation diagrams on pages 23 through 28 in back of manual for suggested piping arrangements. WATER LINE CONNECTIONS This manual provides detailed installation diagrams see back section of this manual for typical methods of application for the water heaters. Page 15 7. After energizing the gas valve, the control will keep the ignitor on for a short predetermined time period, then remove power to the ignitor. 8. After an additional 1 second, the control will monitor the flame sense probe to confirm a flame is present. If a flame is not verified within this time period, the controller will immediately deenergize close the gas valve, and return to step two of the process. See section below Appliance Ignition Failure. 9. Page 16 GAS VALVE LED FLASHING NO LOW VOLTAGE Figure 20 24V AC LED Off This condition results from a failure to establish burner ignition after three successive trials. In such cases 1. Investigate the possible cause and remedy any observations. 2. Momentarily depress the button on the display panel to reset the lockout condition. 3. Confirm proper appliance operation. Possible Cause 1. 2. 3. 4. 5. 6. 7. 8. 9. 10. Page 17 Display Flashes "05" when button is pressed Possible Cause Remedy 1. Temperature Probe wiring open 1. Repair Wiring 2. Defective probe 2. Replace probe Display Flashes "15" when button is pressed Possible Cause Remedy CONTROL BAD, All LEDs Flashing 1. No water in tank and tank in freezing conditions 1. The symptom does not reflect a control problem 2. Water in tank above freezing 2. Temperature probe out of tolerance, replace temp. Page 18 PRIOR TO START UP ADJUSTMENT PROCEDURE REQUIRED ABILITY INITIAL STARTUP INSTALLATION OR SERVICE OF THIS WATER HEATER REQUIRES ABILITY EQUIVALENT TO THAT OF A LICENSED TRADESMAN IN THE FIELD INVOLVED. <https://complektuha.com/UserFiles/dc5-gate-motor-manual.xml>

LP, Low Gas Pressure. 1911494. 1911494. Transformer. 192608. 192608. Valve, Natural Gas. 1945365. 1945365. Valve, LP Gas. 1945366. 1945366. Cable Assembly, Igniter. 194937. 194937. Pump, Recirculation. 194799. 194799. Tee, NonReducing. 194870. 194870. Tube, Closed End Dip. 194924. 194924. Tube, Inlet. 194820. 194820. Vent, Automatic Air. 194830. 194830. Standard hardware items may be purchased locally. Switch, Low Gas Pressure. 1911496. 1911496. LP Gas. 1911494. 1911494. Tee, NonReducing. 40119. 40119. Valve, NAT Gas. 1945365. 1945365. Valve, LP Gas. 1945366. 1945366. Orifice, NAT. 1924777. 192477. Orifice, LP.



<http://www.drupalitalia.org/node/71813>

1924778. 1924779. Orifice holder. 192447. 192447. Standard hardware items may be purchased locally. Flange Burner. 194960. 194960. Gasket. 194817. 194817. Gasket, Burner. 194777. 195016. Gasket Viewport. 194827. 194827. Ignitor. 192334. 192334. Screw, Socket Head Cap. 192515. 192515. Sensor, Flame. 1947761. 1947761. Window, Observation. 987583. 987583. Standard hardware items may be purchased locally. Control Box. 194857. 194857. LED w. Lead Wire. 194959. 194959. This means that at no cost to you, we may receive a small commission for made purchases. Whether you lost your original A.O. Smith water heater manual or the previous homeowners did not leave it behind, below you'll find links to download user manuals in pdf format for the most popular A.O. Smith residential water heaters. Need to Hire a Plumber. Get a free estimate online from top local home service pros in your area. Use the search box below to quickly find your model number. You can either leftclick on the link to open the manual in a new tab or rightclick and save a copy directly on your computer. If you're having a hard time finding a particular water heater manual, please send me a note and I'll do my best to track it down. Can you assist Reply Keith November 24, 2018 at 620 pm Was this found. I am looking for the manual as well. Reply Anthony November 28, 2018 at 541 pm This was a hard one to locate. It appears it falls under a general "Residential Electric Water Heater" owner's manual which covers many legacy models. I added it to the table above but here's the Link. Can you help Reply Anthony November 12, 2018 at 407 pm Sorry Tom. All I could find is the parts list. I'd recommend contacting AO Smith on this one Reply NB April 20, 2019 at 952 pm I need help on finding BTU size on model FGR75 250. My gas water heater label is faded,

unreadable. Appreciate is advance. Reply Anthony April 22, 2019 at 838 pm 76k BTU Reply Vlad September 10, 2019 at 724 pm Thanks a lot for all help you've provided to people.

<http://www.dbgroup-portugal.com/images/bosch-washer-was20160uc-manual.pdf>



I am trying to determine age of my W.H. by American water heater co. Reply Anthony September 16, 2019 at 437 pm Thanks for commenting. I wish I had the time to respond to every comment on the site but it's just something I do on the side so time is limited. Check out the " How to Determine the Age of a Water Heater " page. In your case, the manufacture date would be the 20th week of 2005. As for what the replacement model would be, see our American Water Heaters page for current recommendations but you may simply wish to contact the brand directly Reply Anthony Spino January 26, 2020 at 1135 am I NEED MANUAL FOR GPDC50L 200 Reply Anthony January 27, 2020 at 352 pm It should fall under the ProMax Power DirectVent family Reply Julia March 31, 2020 at 1035 pm I'm looking for THE MANUAL FOR AN ELSF 40 9017. Can you help me please. Reply Wolfgang Ruegner June 28, 2020 at 108 am Need an English manual for water heater A.O. Smith Energy Saver Reply Leave a Comment Cancel reply Comment Name Email Website Save my name, email, and website in this browser for the next time I comment. Search for Need help with a repair or install. Please check your inbox, and if you can't find it, check your spam folder to make sure it didnt end up there. Please also check your spam folder. This unit will produce condensationquite heavily at times. The outlet drain hose must be allowed to drain. Exhaust Vent piping must also drain condensate. Code 11 error would imply that these must be checked. 90% of the time this problem is related to installation issues with either the vent or drain. Login to post How do I fix the problem You do this by checking for continuity through it with all power off. If you need to replace this be very careful as it will break if you bump the box to hard. You should check all your limit switches at the same time. Good luck.The diagram is not very helpful. I have a red and black hot lead and a white neutral. Where do they all go. I want to make the motor go ccw.

<https://ddim.com/images/bosch-washer-service-manuals.pdf>

COMMERCIAL GAS WATER HEATER

GAS-FIRED POWER BURNER FOR DOMESTIC HOT WATER





• INSTALLATION • OPERATION • SERVICE • MAINTENANCE • LIMITED WARRANTY

WARNING: If the information in these instructions is not followed exactly, a fire or explosion may result causing property damage, personal injury or death.

- Do not store or use gasoline or other flammable vapors and liquids in the vicinity of this or any other appliances.
- NEVER TO-DO IT YOUR OWNLY HAND.
- Do not try to light any appliance.
- Do not touch any electrical controls. Do not use any gloves in your building.
- Immediately call your gas supplier from a neighbor's phone. Follow the gas supplier's instructions.
- If you cannot reach your gas supplier, call the fire department.
- Installation and service must be performed by a qualified installation service agency or the gas supplier.



Thank you for buying the most efficient water heater from A.O. Smith Water Products Company. We appreciate your confidence in our technology.

CAUTION

NEVER REWIRE OR BURN A WIRE OR CABLE IN THE VICINITY OF THIS APPLIANCE. NEVER REWIRE OR BURN A WIRE OR CABLE IN THE VICINITY OF THIS APPLIANCE. NEVER REWIRE OR BURN A WIRE OR CABLE IN THE VICINITY OF THIS APPLIANCE.

A.O. SMITH
WATER PRODUCTS
COMPANY

COMMERCIAL & RESIDENTIAL WATER HEATERS
 10000 W. 10th Street, Tulsa, Oklahoma 74117
 (918) 438-2222

Station Monitr Station Monitr Station Monitr Station Monitr Use Kenwood TR250 Microphone In
Radio Serv.So please help us by uploading 1 new document or like us to download.

avtomix.com/upload/files/conia-ca30003-manual.pdf

<http://www.drupalitalia.org/node/71814>